



ALUMINUM COMPOSITE WALL PANEL SYSTEMS

Functionally Designed Cladding Systems



COATED METALS GROUP



COATED METALS GROUP

WWW.CMGMETALS.COM

CMG ACM WALL PANEL SYSTEMS

CMG Aluminum Composite Wall Panel Systems offer incomparable design flexibility to achieve dramatic finished appearance and impact. Manufactured to exacting tolerances and standards using state-of-the-art computerized equipment, these systems meet the highest performance testing standards and requirements. A wide variety of available material sizes and finishes provides for an endless array of design options. Simplicity of design coupled with CMG's renowned attention to quality result in an unmatched finished product exceeding the expectation of designer, contractor and building owner alike.

OVERALL PANEL SYSTEM FEATURES

- Superior flatness and design flexibility
- Available in a variety of thicknesses
- Available in a variety of high performance finishes
- Curved and complex panel shapes available
- Finish warranties available up to 30 years
- Up to 5' x 16' panel sizes



SYSTEM 1000

Sealed Joint System

CMG System 1000 is a watertight, sealed joint system—an economical solution where a sealed application is required. System 1000 is non-sequentially installed allowing each panel to be adjusted and modified individually. Panel system depth can be adjusted to meet variable design criteria.

Features

- Watertight, sealed joint design
- Non-sequential installation
- Easy, economical installation

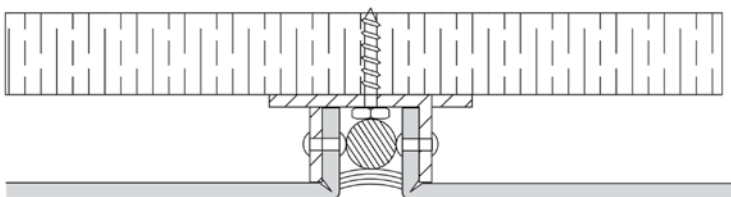

PORSCHE

SYSTEM 2000

Rain Screen System

CMG System 2000 is the industry standard bearer for pressure-equalized, rear ventilated rain screen panel systems. The next generation of dry-joint panel system design, System 2000 introduces a proprietary joint design that eliminates virtually all exposed fasteners, resulting in the cleanest panel joint available for superior appearance. Tested to meet the industry's highest performance standards, System 2000 is the architect's choice for stunning design and unmatched performance.

Features

- Sequentially installed rear-ventilated rain screen system
- No exposed fasteners
- Proprietary extruded aluminum attachment system
- Unique design allowing for efficient installation

Tests

- ASTM E283
- ASTM E330
- ASTM E331
- AAMA 508

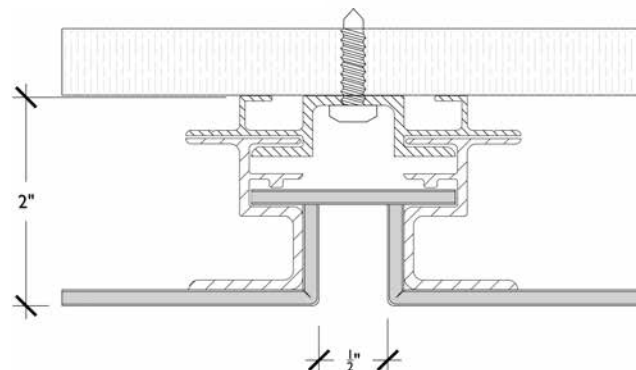

DON MILLER BODY SHOP

DON MILLER
BODY SHOP

SYSTEM 3000

Exposed Fasteners

CMG System 3000 offers a simple, exposed fastener open joint design in order to provide an economical solution with a high-end appearance. System 3000 offers a high tech industrial look in a non-sequential, easy-to-mount system. Contractor and budget friendly, System 3000 is the choice when facing tight schedules and budgets.

Features

- Minimal, cost effective design
- Quick and easy installation
- Non-sequential installation

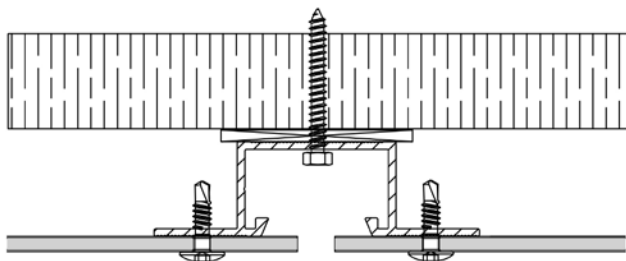



SYSTEM 4000

Spandrel Panel

CMG System 4000 panels are insulated core laminated panels for use in a glazed-in application. Panels can be fabricated to a variety of widths and sizes to accommodate virtually any requirement for glazed-in, insulated spandrel panels. Exacting tolerances ensure proper fit and finish.

Features

- Variable panel thicknesses available
- Insulated core
- Fully laminated for drop-in installation

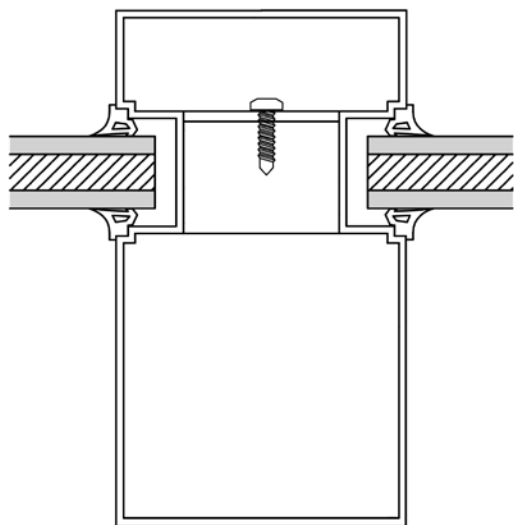



SYSTEM 5000

Column Covers

CMG System 5000 column covers offer an easy-to-install solution for cladding columns and other structural elements. Panels can be formed in quarter-round and half-round sections and can be segmented to fit virtually any application. Continuous column panels can be provided up to 16' long.

Features

- Maximum 16' length available
- Hairline or standard reveal joints available
- Quick and easy installation

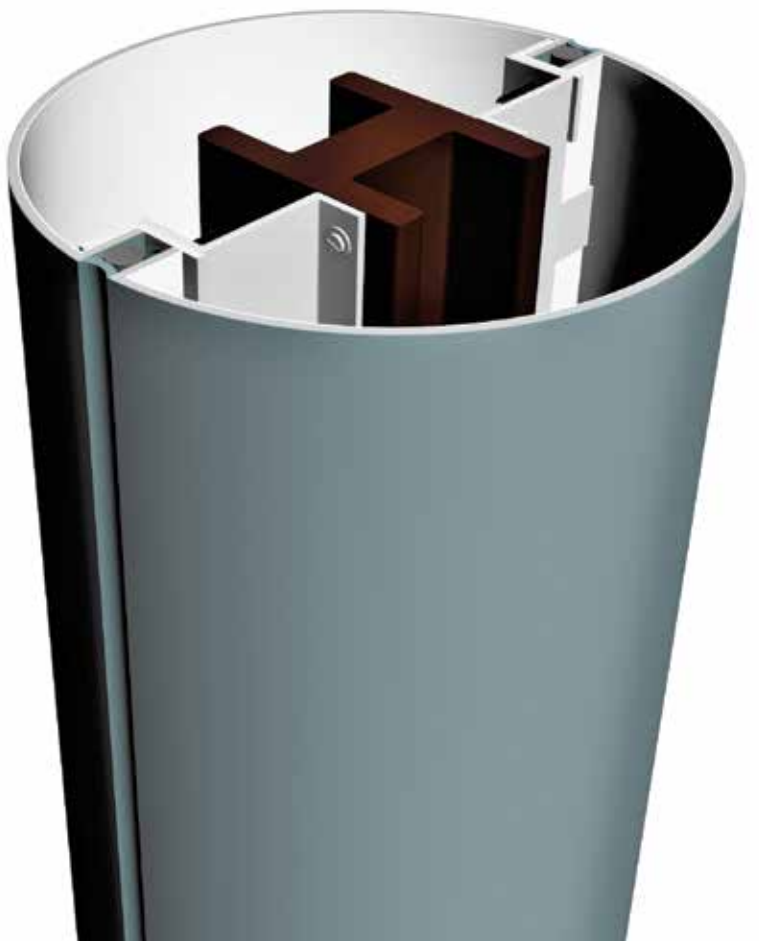



Over 30 Years of Experience

High Quality Products at Competitive Prices

Who We Are

Simply put, CMG manufactures the highest quality architectural building products available at extremely competitive prices. Whether it is slit coil, flat sheets, pre-formed panel systems or rainware, CMG products are manufactured to exacting standards. All CMG steel is produced domestically and specified to tight tolerances resulting in uncommon uniformity. Our wide selection of finishes are produced from coatings that are the very best available. We back this claim with the most comprehensive finish warranty in the industry.

WWW.CMGMETALS.COM

CMG Denver

2525 West Barberry Place
Denver, CO 80204
Phone: 303-623-5333
Fax: 303-623-3738
Toll-Free: 877-623-5333

CMG Indianapolis

455 Rawles Court
Indianapolis, IN 46229
Phone: 317-890-1999
Fax: 317-890-0950
Toll-Free: 866-694-1999

CMG Minneapolis

6801 Shingle Creek Parkway
Suite 1000
Brooklyn Center, MN 55430
Phone: 763-561-5000
Fax: 763-561-5001
Toll-Free: 855-561-5160

CMG Madison Headquarters

300 Yard Drive
Verona, WI 53593
Phone: 608-826-0356
Fax: 608-826-4264
Toll-Free: 800-784-0356



COATED METALS GROUP